

CPR Training Model

Sherpa Plus

USER'S GUIDE

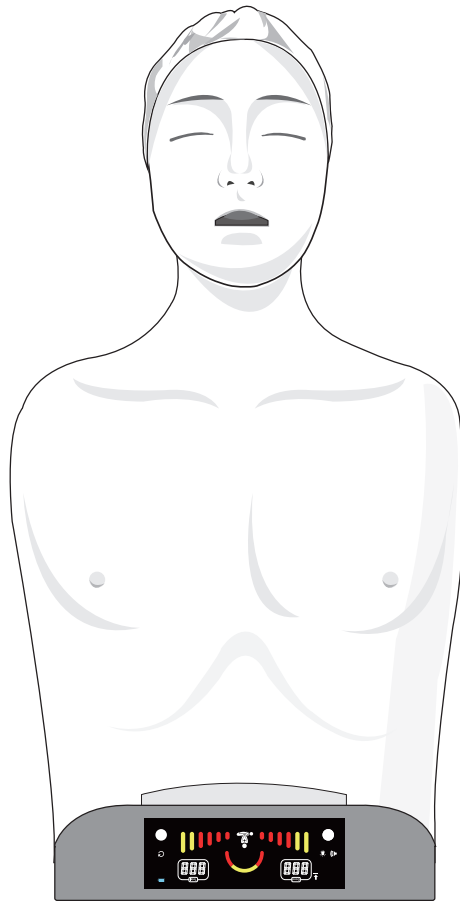

Product Information

Trade name	Sherpa Plus
Model name	BT-SEEM-P
Manufacturer	BT Inc.
Address	A-313, Samsung Techno-valley, 140, Tongil-ro, Deogyang-Gu, Goyang-Si, Gyeonggi-do, 10594, Republic of Korea
Certification	

Product Specifications

Dimensions	335 x 650 x 215 mm
Weight	4.4kg
Battery	6EA of LR14 (C-type, 1.5V)
Power Converter	Input : AC 100-240V ~, 50/60Hz, 0.4A Output : DC 12V, 1.5A

After service

Website	www.btinc.co.kr
Address	A-313, Samsung Techno-valley, 140, Tongil-ro, Deogyang-Gu, Goyang-Si, Gyeonggi-do, 10594, Republic of Korea
Telephone	02-2038-2903
E-mail	btinc@btinc.co.kr



Cautions for battery disposal

Please follow the regulations of corresponding area for the disposal of used batteries.

Cautions

Please read carefully to ensure correct usage and user's safety through understanding of the product.

- ① Use only components provided or approved by BT Inc.
- ② Do not use the product for purposes other than described in the manual.
- ③ If you disassemble or modify the product without any permission by BT Inc, the warranty will be void. Also, making imitated or altered products for commercial purposes are prohibited by law.
- ④ If the product is overheating or emits a burning odor during usage, turn off the power switch, unplug the power adaptor and call the customer service center.
- ⑤ Keep the product away from water and moisture area.
- ⑥ Do not use the product near strong magnetic fields or high voltage power lines.
- ⑦ Do not use the product and unplug the power adapter during lightning storms. It can cause malfunction of the product and increase the risk of an electric shock.
- ⑧ The product may malfunction under the extreme weather conditions.
(Operation temperature : 0°C~40°C (32°F~104°F), Storage temperature : -10°C~50°C (14°F~122°F))
- ⑨ Do not keep the product near hot or cold environments as possible. Deterioration of product or internal damage may occur from extreme weather conditions.
- ⑩ Never clean the product with chemicals such as solvent, benzene or thinner as these may cause fire ignition or surface deterioration.
- ⑪ BT Inc. can change or adjust the product specification without any notice in order to improve the product.

Start up

Thank you for purchasing the Sherpa Plus, CPR trainer.

CPR (Cardiopulmonary resuscitation) is an emergency procedure in which the heart and lungs are made to work by compressing the chest overlying the heart and forcing air into the lungs, CPR is used to maintain circulation when the heart has stopped pumping on its own.

The Sherpa Plus is an advanced CPR trainer for teaching the importance and correct procedures of CPR.

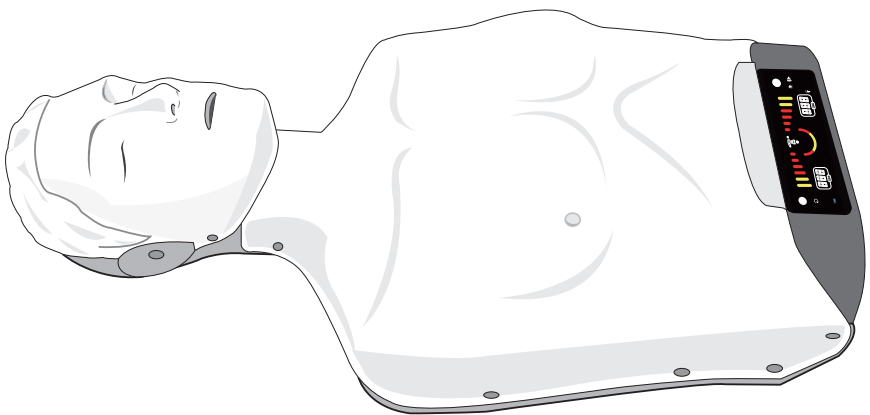

Components

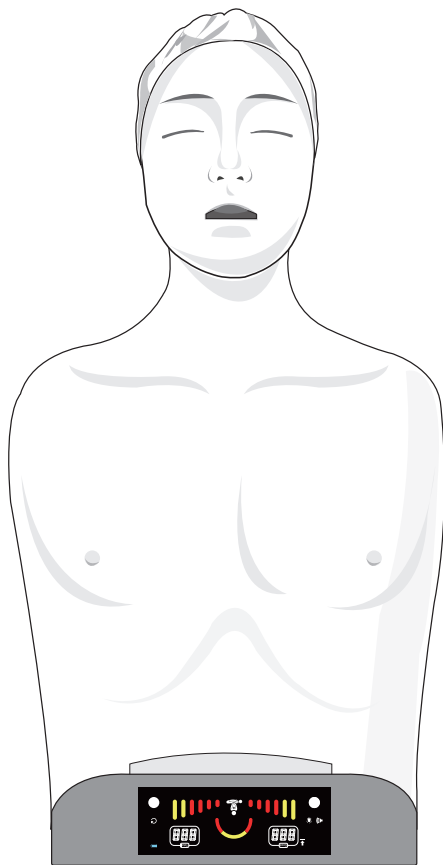

Adult Torso Manikin

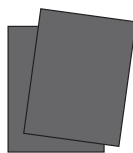

Magnetic sticker
for AED trainer pads

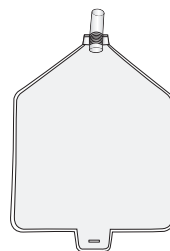

Lung bag

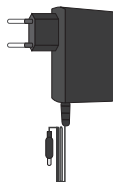

Power adaptor



Face Skin

* Additional components – Storage case, User guide, USB Cable (Power bank connector)

Component

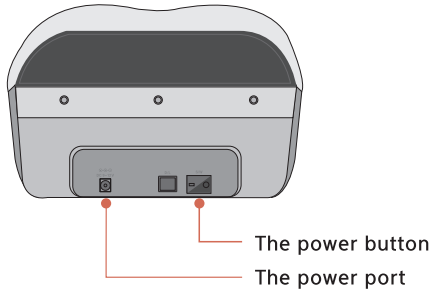
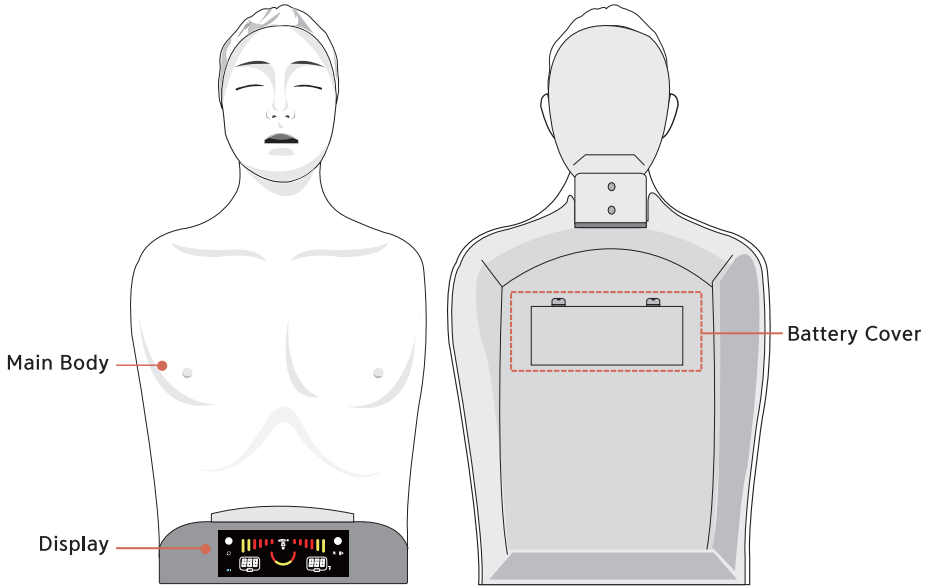

Power connections

<Battery power supply>

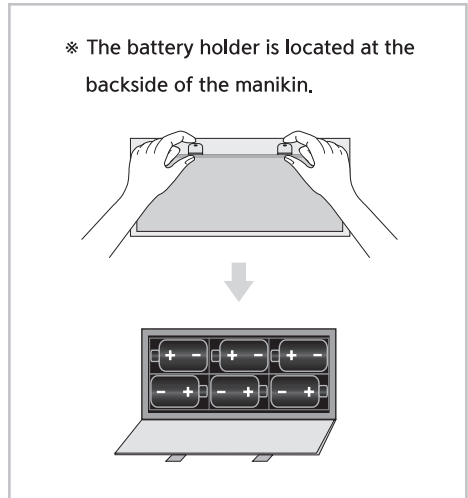
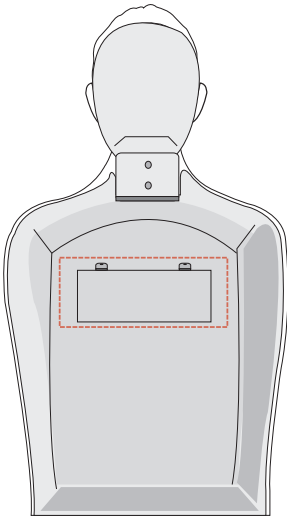

- ① Open the battery cover at the backside of the manikin by pressing the stoppers with both index fingers.
- ② Insert 6 batteries into the battery holder with correct polarities.
- ③ Use LR14 (C-type, 1.5V) standard batteries only.

<External AC Power Supply >

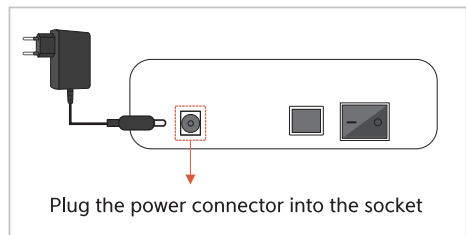
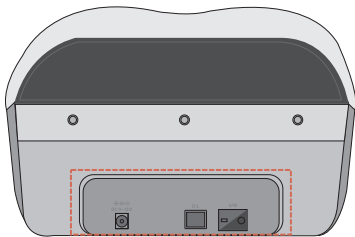

Plug the power connector into the socket

- ※ Use only the power converter supplied by manufacturer.
- ※ In case of using a power bank, please use an included USB cable.
- ※ Some models of power banks may not be compatible with product.

Change the lung airbag

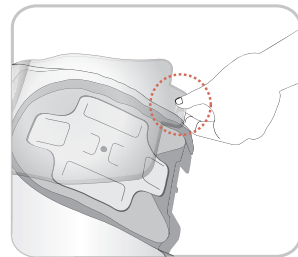
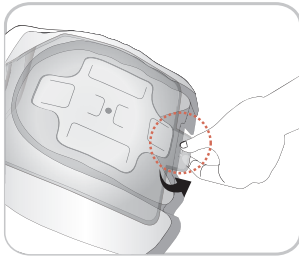
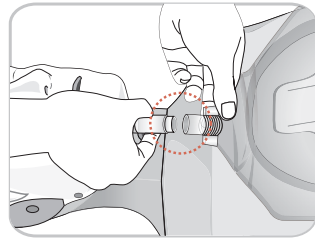
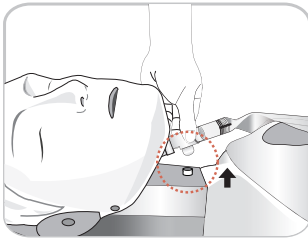
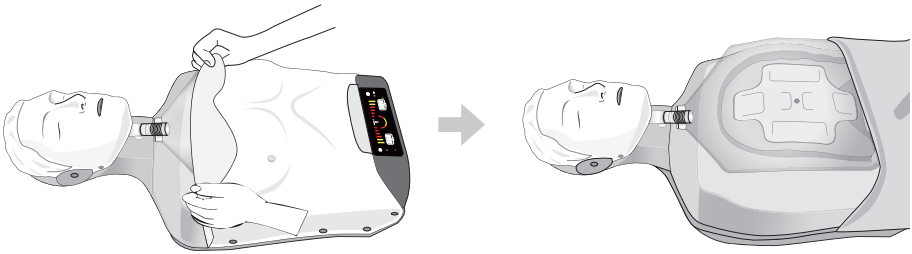

- ① Separate the chest skin from the manikin up to the abdomen.
- ② Disconnect the connector of the lung bag connected to the face of the manikin to disconnect it.
- ③ Unhook the lower part of lung bag from the chest plate of manikin, take the lung out.

※ When connecting the lung bag, install it in reverse order.

Use the magnetic papers

<AED Pads>

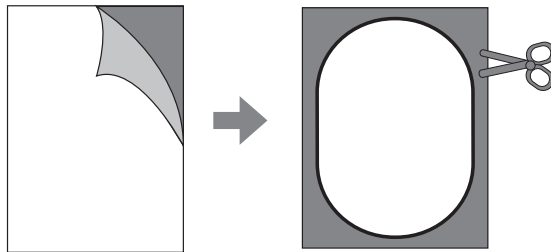
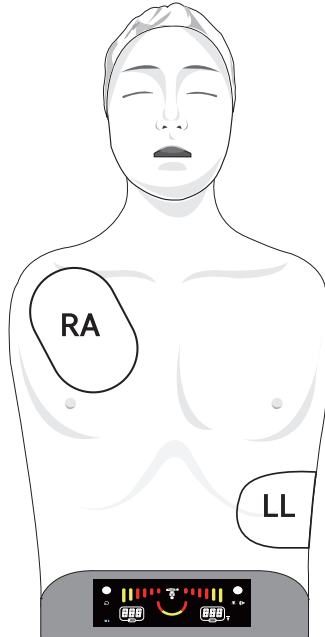

- ① Prepare the AED trainer.
- ② Remove the release liner from the provided magnetic stickers.
- ③ Put magnetic stickers on AED trainer's pads.
- ④ Cut the outer edge of magnetic stickers.
- ⑤ AED trainer's pad will be attached to the manikin due to embedded magnets inside of the manikin.

※ Adhesion may vary depending on the condition and location of pads.

Basic Functions

<Chest Compression>

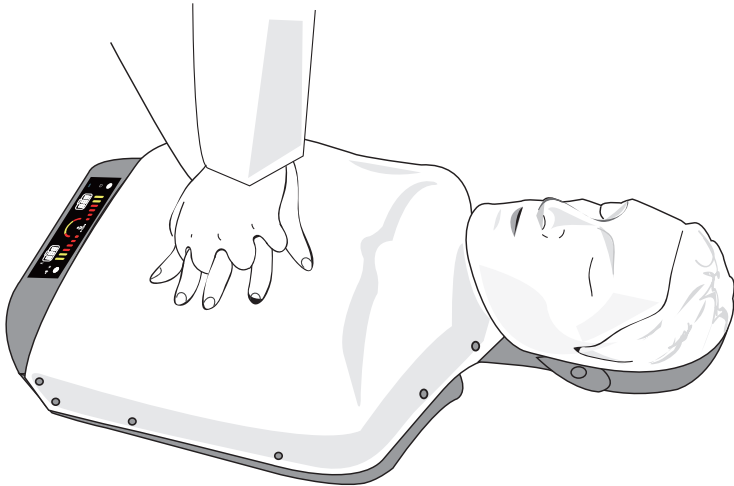

- ① Connect the power adaptor or insert fully charged batteries, then press and release the power button.
- ② When the display is on, select the display option and start the chest compression.
- ③ Compression depth, compression rate, total compression counts and correct compression counts are displayed on the LED panel.

Basic Functions

<Opening Airway>

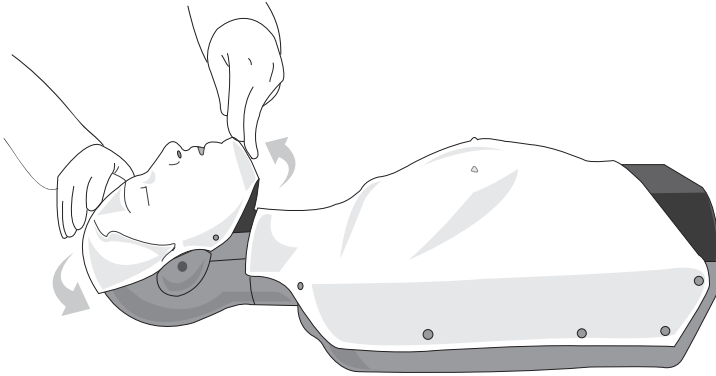

<Ventilation>

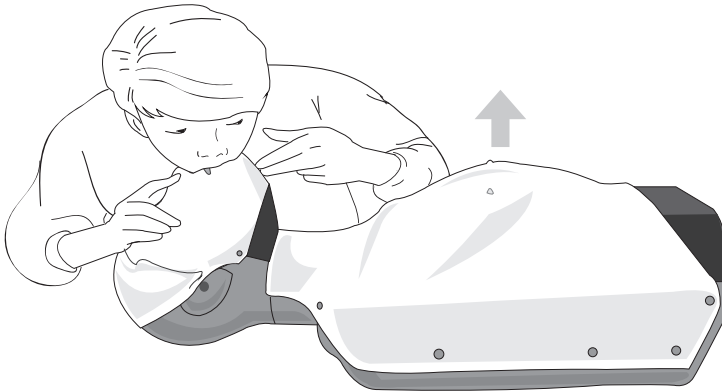

- ① Tilt the head back to open the airway.
- ② Pinch the nose of the manikin and conduct mouth to mouth resuscitation.
(Pay attention to the chest rising.)
- ③ Ventilation number, expiratory time, the number of correct ventilation and total ventilation are displayed on the LED panel.

Basic Functions

<Layout of LED Panel >

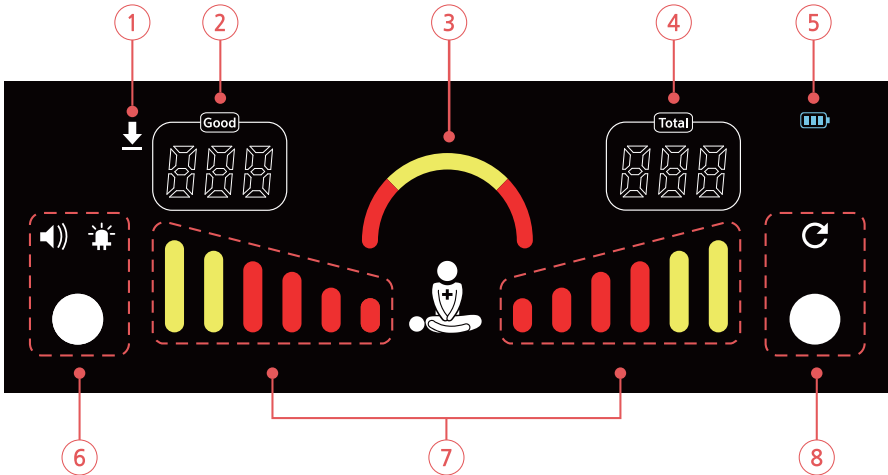

① LED Displaying Chest compression On / LED Displaying Ventilation Off

② Number of Good chest compression / Hand location / Compression depth / Number of Good ventilation / Ventilation volume/
Hand location in real-time, Compression depth, Displaying the number of good compression after training
Ventilation volume in real-time, Displaying the number of ventilation after training

When there is no input, the number of good compression and the number of ventilation is being displayed repeatedly

③ Displaying Compression rate / Expiratory time during ventilation in 3 stages

④ Total compression number / ventilation number

⑤ Battery status

Option button in 4 stages (repeated)

Sortation	Stage 1	Stage 2	Stage 3	Stage 4
Sound	On	Off	Off	On
LED	On	Off	On	Off



⑦ Compression Depth / Incomplete recoil / Volume of ventilation

⑧ Reset button



* Battery saver mode will be automatically turned on and the LED panel will stop displaying when chest compressions are not detected for 60 minutes. Press the ⑥ or ⑧ button to begin again.

Basic Functions

<Compression Depth / Ventilation volume>

LED	Compression Depth	Ventilation volume
	Insufficient	Insufficient
	Correct	Correct
	Over-compression	Excessive

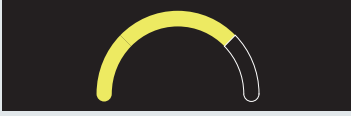
<Compression rate / Expiratory time >

LED	Compression rate	Expiratory time
	Slow	Slow
	Correct	Correct
	Fast	Fast

Basic Functions

<Display layout>

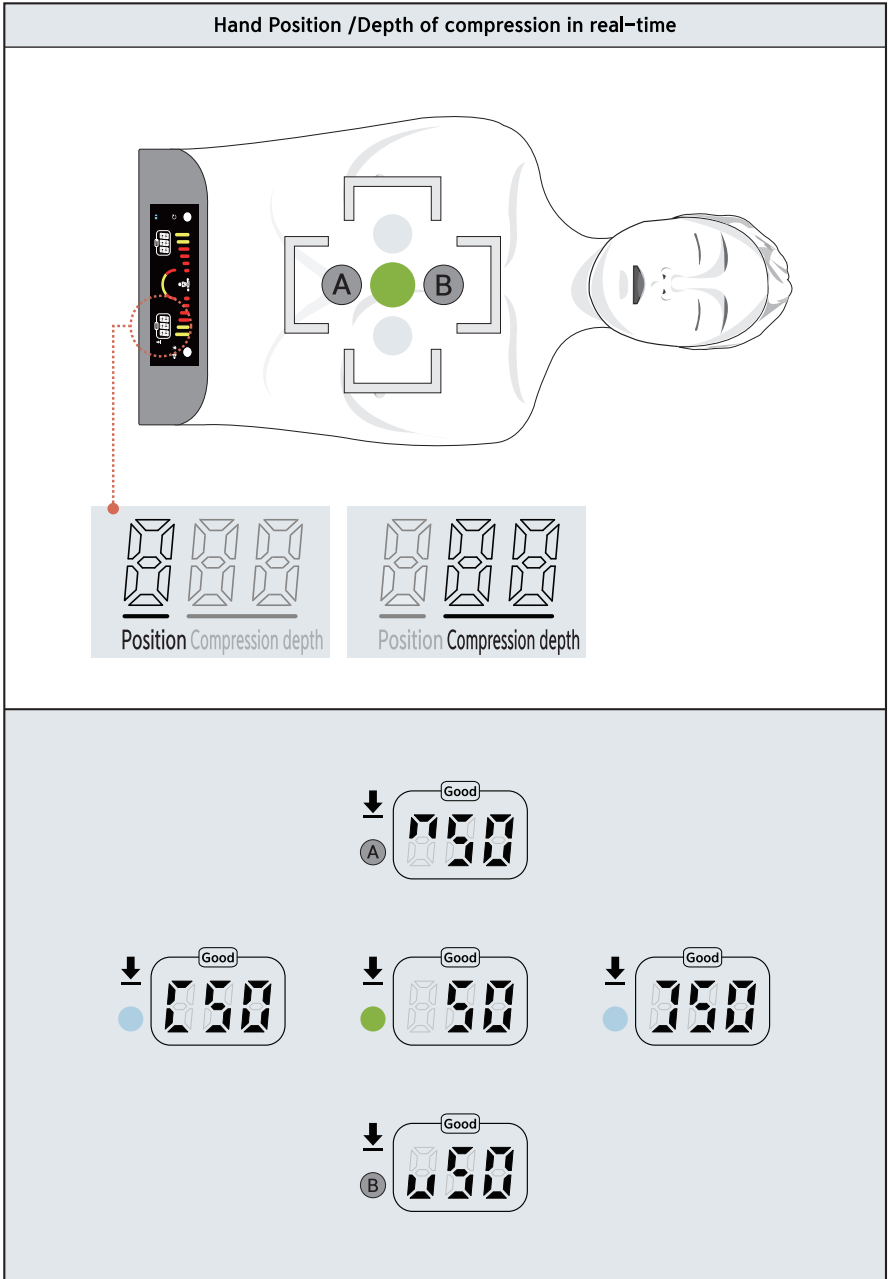

CPR Training Model

Sherpa Plus

A-313, Samsung Techno-valley, 140, Tongil-ro,
Deogyang-gu, Goyang-si, Gyeonggi-do, 10594, Republic of Korea
Homepage: www.btinc.co.kr / E-mail: btinc@btinc.co.kr
Tel: +82-2-2038-2903, +82-51-903-1144 / Fax: +82 303-3130-0607

Copyright(c) BT Inc. All rights reserved.